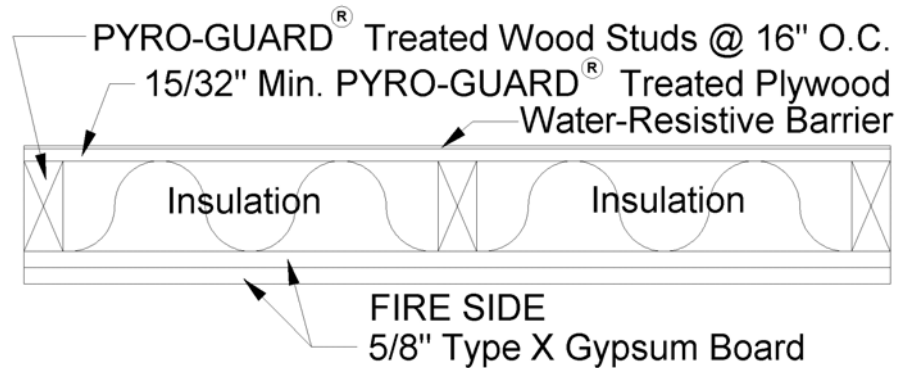

FIGURE 4: 2-HOUR FIRE-RESISTANCE RATED EXTERIOR WALL ASSEMBLY

Use where wall is required to be fire rated from the interior side only



INTERIOR SIDE: Base layer ⁵/₈ inch (15.88 mm) type X gypsum wallboard applied parallel to studs with 6d coated nails, 1-⁷/₈ inch (228.6 mm) long, 0.0915 inch (2.48 mm) shank, ¼ inch (6.35 mm) heads, 12 inches (304.8 mm) o.c. Face layer ⁵/₈ inch (15.88 mm) type X gypsum wallboard or gypsum veneer base applied at right angles to studs with 8d coated nails, 2-³/₈ inch (60.33 mm) long, 0.113 inch (2.87 mm) shank, ⁹/₃₂ inch (7.14 mm) heads, 8 inches (203.2 mm) o.c. at edges and 12 inches (304.8 mm) o.c. at intermediate studs. **(LOAD-BEARING, 100% of Calculated Design Load)**

STUD CAVITY: Spaces between the studs are completely filled rockwool or slag mineral wool batts weighing not less than 3.3 pounds per cubic foot (1 pound per square foot of wall surface).

EXTERIOR SIDE: Pyro-Guard Treated Plywood fastened at 6 inches on center at edges and 12 inches (304.8 mm) on center in the field covered with a water resistive barrier.

EXTERIOR FINISH: Material and of the thickness required by Table 1405.2 of the IBC installed in accordance with the manufacturers recommendations. Vinyl siding must not be permitted with Type III or IV construction.